

# Service Maintenance Overview

## Dynapac CC1200 18,5 kW

Parts book

### Service Kits & Lubricants

[CC1200 Plus \(18,5 kW\) s/n 10000371xFA017074 - xxA021038 \(digabit.com\)](#)

Service Interval	Service Kit Part Number
50 Hour Service Kit	4812156265
250/750 Hour Service Kit	4812156288
500 Hour Service Kit	4812156266
1000 Hour Service Kit	4812156267
2000 Hour Service Kit	4812156267

Lubricant	Part Number	Qty required at 50 Hour	Qty required at 250	Qty required at 500 Hour Service	Qty required at 1,000 Hour Service	Qty required at 2,000 Hour Service
Dynapac Engine Oil 200 (5L)	4812161855	2	2	N/A	2	2
Dynapac Gear Oil 300 (5L)	4812161883	N/A	N/A	N/A	2	2
Dynapac Coolant 100 (20L)	4812161854	N/A	N/A	N/A	N/A	1
Dynapac Hydraulic 300 (20L)	4812161868	N/A	N/A	N/A	3	3

### Service and maintenance points

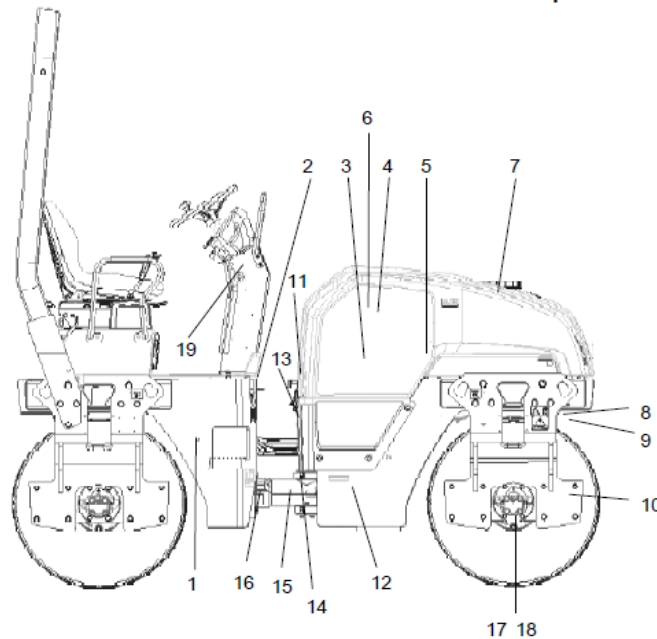

Fig. Service and maintenance points

- |                  |   |                               |
|------------------|---|-------------------------------|
| 1. Fuel tank     | 8. Sprinkler system                       | 15. Steering joint            |
| 2. Refueling     | 9. Scrapers                               | 16. Steering cylinder bracket |
| 3. Cooler        | 10. Shock absorbers and attachment screws | 17. Filler plugs/Drum         |
| 4. Air cleaner   | 11. Hydraulic fluid refilling             | 18. Oil level in drum         |
| 5. Battery       | 12. Hydraulic fluid tank                  | 19. Emergency stop            |
| 6. Diesel engine | 13. Hydraulic fluid filter                |                               |
| 7. Water tank    | 14. Hydraulic fluid level glass           |                               |



# Service Maintenance Overview

Pos	Action	Every 10 hours of operation (Daily)	Every 50 hours of operation (Weekly)	Every 250 hours of operation (Weekly)	Every 500 hours of operation	Every 750 hours of operation	Every 1000 hours of operation	Every 1250 hours of operation	Every 1500 hours of operation	Every 1750 hours of operation	Every 2000 hours of operation	Every 24th month	NOTE
3	Clean the outside of the radiator core	○											In duty environments, as necessary
4	Check coolant level	○											
6	Check the engine oil level	○											Refer to the engine manual
14	Check fluid level in hydraulic reservoir	○											
3	Check for free circulation of cooling air	○											
1	Refuel	○											
7	Fill the water tank	○											
8/21	Check the sprinkler system	○											
9/22	Check the scraper setting	○											
19	Test the brakes	○											
22	Check spring loaded scrapers	○											Option
6	Replace the engine's fuel filter	●		●				●		●			Refer to the engine manual
6	Change the engine's pre-filter	●		●				●		●			Refer to the engine manual
13	Change the hydraulic fluid filter	○		○				○		○			
10	Check rubber elements and bolted joints	○		○				○		○			
4	Clean/Change the air cleaner filter element		○	○				○		○			
4	Check that hoses and couplings are not leaking		○	○				○		○			
15	Grease the steering joint		○	○				○		○			
16	Grease the steering cylinder brackets		○	○				○		○			
6	Change the engine oil and oil filter			●				●		●			Refer to the engine manual
5	Check the battery condition		○	○				○		○			
18	Check the oil level / Change oil in the drums			○				○		○			
11	Check the hydraulic reservoir cover/breather			○				○		○			
6	Lubricate controls and joints			○				○		○			
6	Check engine's V-belt			○				○		○			Refer to the engine manual
3	Check coolant freezing point/Change coolant			○				○		○	●		
12	Drain the condensate from hydraulic reservoir							○		○			
6	Check the engine's toothed belt							○		○			Refer to the engine manual
6	Check engine's valve clearance							○		○			Refer to the engine manual
12	Change the hydraulic fluid									●			
7	Drain and clean the water tank									○			
23	Drain and clean the emulsions tank									○			
1	Drain and clean the fuel tank									○			
	Check the condition of the articulation									○			

○ Check ● Change



# Service Maintenance Overview

## Dynapac CC1200 18,5 kW

### Repair Kits

CC1200					
4700938908	Eccentric shaft kit				<a href="#">4700938908 Eccentric shaft kit (digabit.com)</a>
4700938892	Drum rotating kit				<a href="#">4700938892 Drum rotation kit (digabit.com)</a>
4700938885	Shock absorber kit, drum				<a href="#">4700938885 Shock absorber kit, drum (digabit.com)</a>
4812159961	Scraper kit				<a href="#">4812159961 Scraper kit (digabit.com)</a>
4700938575	Steering hitch kit				<a href="#">4700938575 Steering hitch kit (digabit.com)</a>

### General Comments

Inspected By: \_\_\_\_\_ Signature: \_\_\_\_\_

To be used as a reference only, always refer to the applicable Operators & Maintenance manual for confirm of correct service kits, lubricants and inspection tasks.



# Service Checklist 10 Hours (Daily)



## Dynapac CC1200 18,5 kW

Machine Model: \_\_\_\_\_

Serial Number: \_\_\_\_\_

Hour Meter Reading: \_\_\_\_\_

Date of Inspection: \_\_\_\_\_

### Required Service Kits & Lubricants

Nil Required Inspection Only

### General Inspection Tasks

Task	OK	Not Ok	Comments
Check Light Functions, Work Lights, Beacon Light, etc.			
Check Function of Back Up Alarm			
Check Condition of Seat Belt and Mechanisms			
Check Function of Steering System			
Check Function of All Switches, Gauges and Indicators			
Check All Systems and Functions Operate as Per Operators Manual			
Check Evidence of Leaks in Systems			
Check Drum Scraper Position and Adjustment			
Check & Clean Free Circulation of Cooling Air			
Check Function of Brake System			
Check Drum Shock Absorbers and Bolts			
Check Sprinkler System Function			
Check Platform Mount Rubbers			
Check & Clean Battery Condition			
Check Level Engine Oil Top Up As Required			
Check Level Hydraulic Oil Top Up As Required			
Check Level Coolant Top Up As Required			
Check Main Engine Air Filter Element			
Check Safety Engine Air Filter Element			

### General Comments

--

Inspected By: \_\_\_\_\_

Signature: \_\_\_\_\_

To be used as a reference only, always refer to the applicable Operators & Maintenance manual for confirm of correct service kits, lubricants and inspection tasks.





# Service Checklist First 50 Hours



## Dynapac CC1200 18,5 kW

Machine Model: \_\_\_\_\_

Serial Number: \_\_\_\_\_

Hour Meter Reading: \_\_\_\_\_

Date of Inspection: \_\_\_\_\_

### Required Service Kits & Lubricants

Description	Part Number	Qty
Initial 50 Hour Service Kit	4812156265	1
Dynapac engine oil 200 / 5 ltr	4812161855	1

### General Inspection Tasks

Task	OK	Not Ok	Comments
Check Light Functions, Work Lights, Beacon Light, etc.			
Check Function of Back Up Alarm			
Check Condition of Seat Belt and Mechanisms			
Check Function of Steering System			
Check Function of All Switches, Gauges and Indicators			
Check All Systems and Functions Operate as Per Operators Manual			
Check Evidence of Leaks in Systems			
Check Drum Scraper Position and Adjustment			
Check & Clean Free Circulation of Cooling Air			
Check Function of Brake System			
Check Drum Shock Absorbers and Bolts			
Check Platform Mount Rubbers			
Check & Clean Battery Condition			
Check Level Hydraulic Oil			
Check Level Coolant			
Check Main Engine Air Filter Element			
Check Safety Engine Air Filter Element			

### Maintenance Tasks

Task	Completed (mark with X)	Comments
Grease Articulation Point and Steering		
Replace Engine Oil		
Replace Engine Oil Filter		
Replace Hydraulic Oil Filter		

### General Comments

------------------

Completed By: \_\_\_\_\_

Signature: \_\_\_\_\_



# Service Checklist First 50 Hours



To be used as a reference only, always refer to the applicable Operators & Maintenance manual for confirm of correct service kits, lubricants and inspection tasks.





# Service Maintenance Overview



## Dynapac CC1200 18,5 kW

Machine Model: \_\_\_\_\_

Serial Number: \_\_\_\_\_

Hour Meter Reading: \_\_\_\_\_

Date of Inspection: \_\_\_\_\_

### Required Service Kits & Lubricants

Description	Part Number	Qty
250 Hour Service Kit	4812156288	1
Dynapac Engine Oil 200 (5L)	4812161855	2

### General Inspection Tasks

Task	OK	Not Ok	Comments
Check Light Functions, Work Lights, Beacon Light, etc.			
Check Function of Back Up Alarm			
Check Condition of Seat Belt and Mechanisms			
Check Function of Steering System			
Check Function of All Switches, Gauges and Indicators			
Check All Systems and Functions Operate as Per Operators Manual			
Check Evidence of Leaks in Systems			
Check Drum Scraper Position and Adjustment			
Check & Clean Free Circulation of Cooling Air			
Check Function of Brake System			
Check Sprinkler System Function			
Check Drum Shock Absorbers and Bolts			
Check Platform Mount Rubbers			
Check & Clean Battery Condition			
Check Level Hydraulic Oil Top Up As Required			
Check Level Coolant Top Up As Required			
Check Main Engine Air Filter Element			
Check Safety Engine Air Filter Element			

### Maintenance Tasks

Task	Completed (mark with X)	Comments
Replace Engine Oil		
Replace Engine Oil Filter		
Grease Articulation Point and Steering		
Grease Controls and Joints		



## General Comments

Inspected By: \_\_\_\_\_

Signature: \_\_\_\_\_

To be used as a reference only, always refer to the applicable Operators & Maintenance manual for confirm of correct service kits, lubricants and inspection tasks.





# Service Checklist 500 Hours



## Dynapac CC1200 18,5 kW

Machine Model: \_\_\_\_\_

Serial Number: \_\_\_\_\_

Hour Meter Reading: \_\_\_\_\_

Date of Inspection: \_\_\_\_\_

### Required Service Kits & Lubricants

Description	Part Number	Qty
500 Hour Service Kit	4812156266	1

### General Inspection Tasks

Task	OK	Not Ok	Comments
Check Light Functions, Work Lights, Beacon Light, etc.			
Check Function of Back Up Alarm			
Check Condition of Seat Belt and Mechanisms			
Check Function of Steering System			
Check Function of All Switches, Gauges and Indicators			
Check All Systems and Functions Operate as Per Operators Manual			
Check Evidence of Leaks in Systems			
Check Drum Scraper Position and Adjustment			
Check & Clean Free Circulation of Cooling Air			
Check Function of Brake System			
Check Drum Shock Absorbers and Bolts			
Check Sprinkler System Function			
Check Platform Mount Rubbers			
Check & Clean Battery Condition			
Check Level Hydraulic Oil Top Up As Required			
Check Level Coolant Top Up As Required			
Check Level Drum Oil (Front & Rear) Top Up As Required			
Check Safety Engine Air Filter Element			
Check Breather Filter on Hydraulic Reservoir			

### Maintenance Tasks

Task	Completed (mark with X)	Comments
Replace Engine Oil		
Replace Fuel Filter		
Replace Fuel Pre-Filter		
Replace Engine Oil Filter		
Replace Main Engine Air Filter Element		
Grease Controls and Joints		



# Service Checklist 500 Hours



Grease Articulation Point and Steering		
--	--	--

Task Continued	Completed (mark with X)	Comments
Check Engine Drive Belt Tension		

## General Comments

Inspected By: \_\_\_\_\_

Signature: \_\_\_\_\_

To be used as a reference only, always refer to the applicable Operators & Maintenance manual for confirm of correct service kits, lubricants and inspection tasks.





# Service Checklist 1,000 Hours



## Dynapac CC1200 18,5 kW

Machine Model: \_\_\_\_\_

Serial Number: \_\_\_\_\_

Hour Meter Reading: \_\_\_\_\_

Date of Inspection: \_\_\_\_\_

### Required Service Kits & Lubricants

Description	Part Number	Qty
1000 Hour Service Kit	4812156267	1
Dynapac Engine Oil 200 (5L)	4812161855	2
Dynapac Hydraulic 300/20 ltrs	4812161868	3

### General Inspection Tasks

Task	OK	Not Ok	Comments
Check Light Functions, Work Lights, Beacon Light, etc.			
Check Function of Back Up Alarm			
Check Condition of Seat Belt and Mechanisms			
Check Function of Steering System			
Check Function of All Switches, Gauges and Indicators			
Check All Systems and Functions Operate as Per Operators Manual			
Check Evidence of Leaks in Systems			
Check Drum Scraper Position and Adjustment			
Check & Clean Free Circulation of Cooling Air			
Check Function of Brake System			
Check Drum Shock Absorbers and Bolts			
Check Sprinkler System Function			
Check Platform Mount Rubbers			
Check & Clean Battery Condition			
Check Level Hydraulic Oil Top Up As Required			
Check Level Coolant Top Up As Required			
Check Level Drum Oil (Front & Rear) Top Up As Required			
Check Breather Filter on Hydraulic Reservoir			

### Maintenance Tasks

Task	Completed (mark with x)	Comments
Replace Engine Oil		
Replace Fuel Filter		
Replace Fuel Pre-Filter		
Replace Engine Oil Filter		
Replace Hydraulic Oil Filter		
Replace Main Engine Air Filter Element		
Replace Safety Engine Air Filter Element		
Grease Controls and Joints		



# Service Checklist 1,000 Hours



Grease Articulation Point and Steering		
--	--	--

Task Continued	Completed (mark with X)	Comments
Drain Condensate in Hydraulic Reservoir		
Drain Condensate in Fuel Tank		
Check Engine Drive Belt Tension		
Check Engine Valve Clearance		

## General Comments

--

Inspected By: \_\_\_\_\_

Signature: \_\_\_\_\_

To be used as a reference only, always refer to the applicable Operators & Maintenance manual for confirm of correct service kits, lubricants and inspection tasks.





# Service Checklist 2,000 Hours



## Dynapac CC1200 18,5 kW

Machine Model: \_\_\_\_\_

Serial Number: \_\_\_\_\_

Hour Meter Reading: \_\_\_\_\_

Date of Inspection: \_\_\_\_\_

### Required Service Kits & Lubricants

Description	Part Number	Qty
1000 Hour Service Kit	4812156267	1
Dynapac Engine Oil 200 (5L)	4812161855	2
Dynapac Gear Oil 300 (5L)	4812161883	2
Dynapac Coolant 100 (20L)	4812161854	1
Dynapac Hydraulic 300 (20L)	4812161868	3

### General Inspections

Task	OK	Not Ok	Comments
Check Light Functions, Work Lights, Beacon Light, etc.			
Check Function of Back Up Alarm			
Check Condition of Seat Belt and Mechanisms			
Check Function of Steering System			
Check Function of All Switches, Gauges and Indicators			
Check All Systems and Functions Operate as Per Operators Manual			
Check Evidence of Leaks in Systems			
Check Drum Scraper Position and Adjustment			
Check Sprinkler System Function			
Check & Clean Free Circulation of Cooling Air			
Check Function of Brake System			
Check Drum Shock Absorbers and Bolts			
Check Platform Mount Rubbers			
Check & Clean Battery Condition			

### 2,000 Hour Service Checklist

Task	Completed (mark with X)	Comments
Replace Engine Oil		
Replace Hydraulic Oil		
Replace Coolant		
Replace Drum Oil (Front & Rear)		
Replace Fuel Filter		
Replace Fuel Pre-Filter		
Replace Engine Oil Filter		
Replace Hydraulic Oil Filter		
Replace Main Engine Air Filter Element		



# Service Checklist 2,000 Hours



Task Continued	Completed (mark with X)	Comments
Replace Safety Engine Air Filter Element		
Replace Breather Filter on Hydraulic Reservoir		
Grease Controls and Joints		
Grease Articulation Point and Steering		
Drain Condensate in Hydraulic Reservoir		
Drain Condensate in Fuel Tank		
Drain & Clean Water Tank		
Replace Engine Drive Belt		
Check Engine Valve Clearance		

## General Comments

Inspected By: \_\_\_\_\_

Signature: \_\_\_\_\_

To be used as a reference only, always refer to the applicable Operators & Maintenance manual for confirm of correct service kits, lubricants and inspection tasks.

